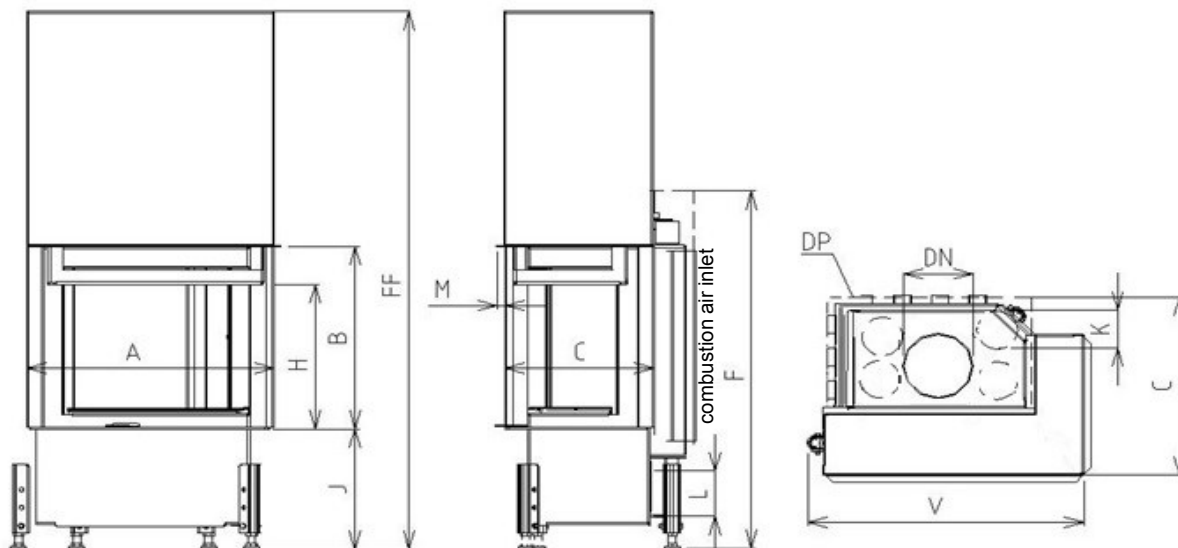

KAZETA R90 60 VD 650/450,510-S/380 (L/P)

Low-energy range 60

Low-energy fireplace insert

Sizes		KAZETA R90 60 VD 650/450- S/380 (L/P)	KAZETA R90 60 VD 650/510- S/380 (L/P)
1	A	mm	650
2	F	mm	1060
3	C	mm	480
4	DN	Ø mm	180
5	B	mm	450
6	FF	mm	1350
7	R	mm	380
8	V	mm	705
9	H	mm	315
10	J	mm	325 + /160/
11	K	Ø mm	4x125
12	L	Ø mm	125
13	M	mm	20
14	N	mm	

Basic design:

Thermodynamic Hearth
 Segment chamotte lining
 Glass Classic
 Inox control grip-handle MP2
 Enviromentally friendly varnish

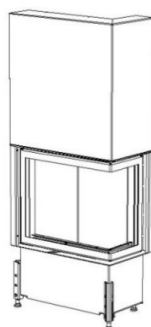

KAZETA R90-S/380 P VD

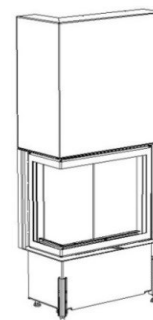

KAZETA R90-S/380 L VD

Technical parameters			
1	Nominal heat output	kW	6,0
2	Pressure required	Pa	12
3	Average efficiency	%	77,6
4	Average flue gas temperature	°C	252
5	Wood consuption	kg/h	2
6	Consumption of combustion air	m ³ /hod	18
7	Emission of CO to 13% O2	%	0,1
8	Flue gas mass flow	g/s	6,4
9	Weight	kg	240
10	Required min. cross section for circulating air - INPUT	cm ²	200
11	Required min. cross section for circulating air - OUTPUT	cm ²	300
12	Three-component insulated chimney - active height 6 m	Ø cm	160
13	Character of building construction with fireplace insert	warm air convection	Yes
		heat storage without conv	No

Optional accessories:

Cover frame (KR)
 Glass Reflex (SR)
 Black printed glass(SM)
 Black printed glass Reflex (SMR)
 External ashtray (VOP)
 Lower hearth (ZO)
 Rear feeding door (PD)
 Vertical heat-storing panel (AZ)

Test Method: ČSN EN 1322/A2:2007, FprEN16510-1, FprEN16510-2-2

Fireplace complies with the requirements: EN 13229, DIN +, BlmSchV-Stufe 2, Commission Regulation (EU) č. 2015/1185 Ecodesign requirements

KOBOK reserves the right to change dimensions and parameters described in these sheets. The current edition can be downloaded from www.KOBOK.sk

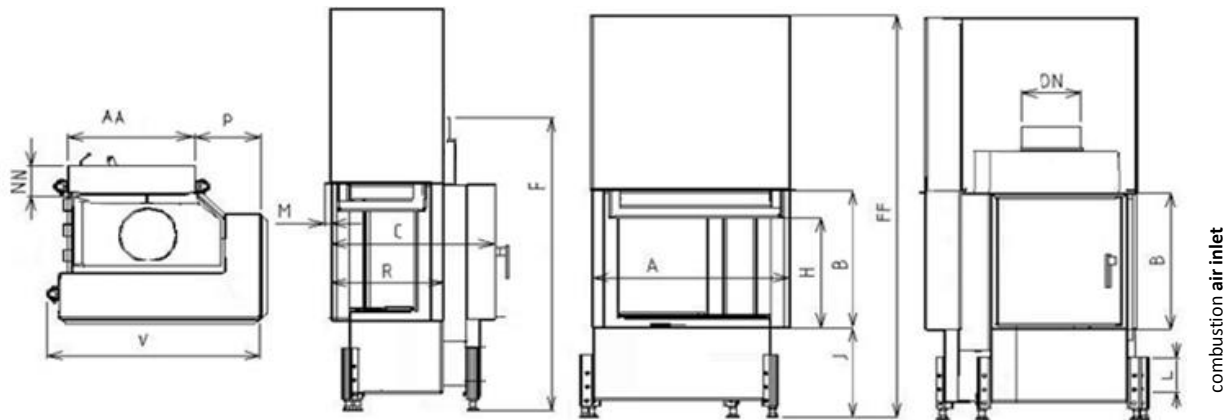
Low-energy fireplace insert

Technical parameters			
1	Nominal heat output	kW	6
2	Pressure required	Pa	12
3	Average efficiency	%	77,6
4	Average flue gas temperature	°C	252
5	Wood consumption	kg/h	2
6	Consumption of combustion air	m ³ /h	18
7	Emission of CO to 13% O ₂	%	0,1
8	Flue gas mass flow	g/s	6,4
9	Weight	kg	280
10	Required min. cross section for circulating air - INPUT	cm ²	200
11	Required min. cross section for circulating air - OUTPUT	cm ²	300
12	Three-component insulated chimney - active height 6 m	Ø cm	160
13	character of building construction with fireplace insert	warm air convection	yes
		heat storage without conv.	no

Optional accessories:

- Cover frame (KR)
- Black printed glass(SM)
- Lower hearth (ZO)
- Convictional casing (DP)
- Heat accumulation quadrant (APO)

	Sizes		KAZETA R90 60	KAZETA R90 60
			VD 650/450- S/380 (L/P) PD 410/450	VD 650/510- S/380 (L/P) PD 410/510
1	A	mm	650	
2	F	mm	1060	1120
3	C	mm	600	
4	DN	Ø mm	180	
5	B	mm	450	510
6	P	mm	200	
7	R	mm	380	
8	AA	mm	410	
9	P	mm	200	
10	J	mm	325 + /160/	
11	FF	mm	1350	1470
12	L	Ø mm	125	
13	NN	mm	150	
14	H	mm	315	375
15	V	mm	705	

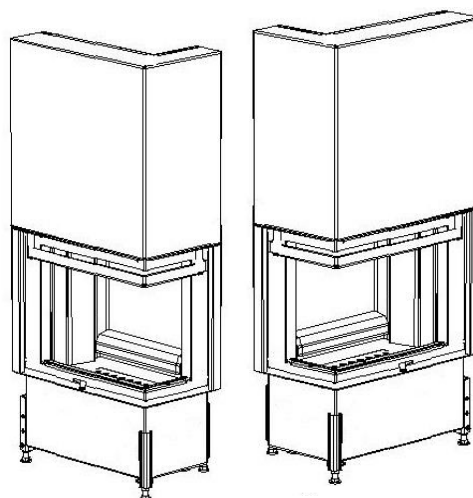

KAZETA R90-S/380 P PD 410

KAZETA R90-S/380 L PD 410